

Refueling Instructions



Trucks or buses should **only** be refueled from a dispenser labeled as **H35**.

1.
Park your vehicle next to the dispenser, turn off the engine, and open the fuel intake.

2.
Go to the point-of-sale and follow the on-screen instructions. The point-of-sale is located on the wall of the building.

3.
Return to the selected dispenser and connect the nozzle to the vehicle's valve.

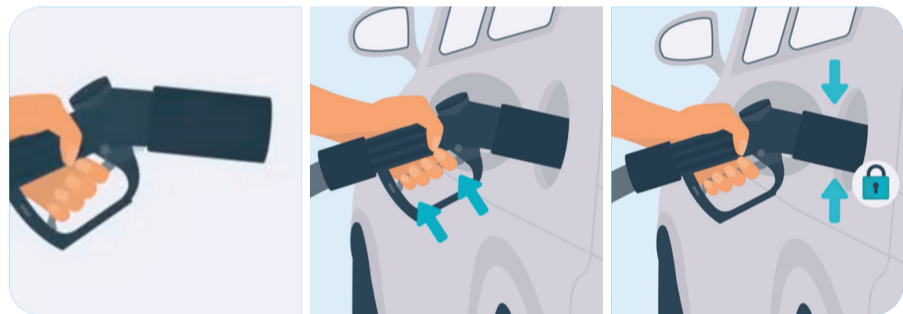

4.
Make sure the nozzle is firmly secured to the vehicle's valve.

5.
To start refueling, press the green button on the dispenser.



6.
When the dispenser indicates the end of the refueling process, unlock the nozzle, disconnect it from the vehicle, and place it on the holder.

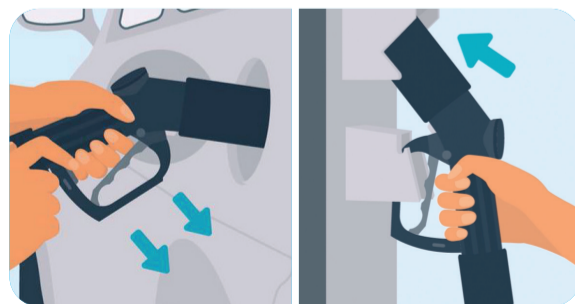

7.
Return to the point-of-sale to collect your receipt or invoice.

Need assistance? Call Us at: 222 136 236.

Safe journey!